

# Cressmoor Prairie Nature Preserve

County: Lake                      Size: 38.09 acres  
Ownership: Shirley Heinze Land Trust



## Location and Access

**Parking and trail.** From the intersection of I-65 and US 6 (Exit #258; also called Ridge Rd), go east on Ridge Rd about 2.5 miles to Lake Park Ave. Turn south (right) on Lake Park Ave, and go about 0.5 mile to the parking lot on the west side of the road. A trail traverses the preserve. Portions of the trail can have standing water during seasonally wet periods of the year.

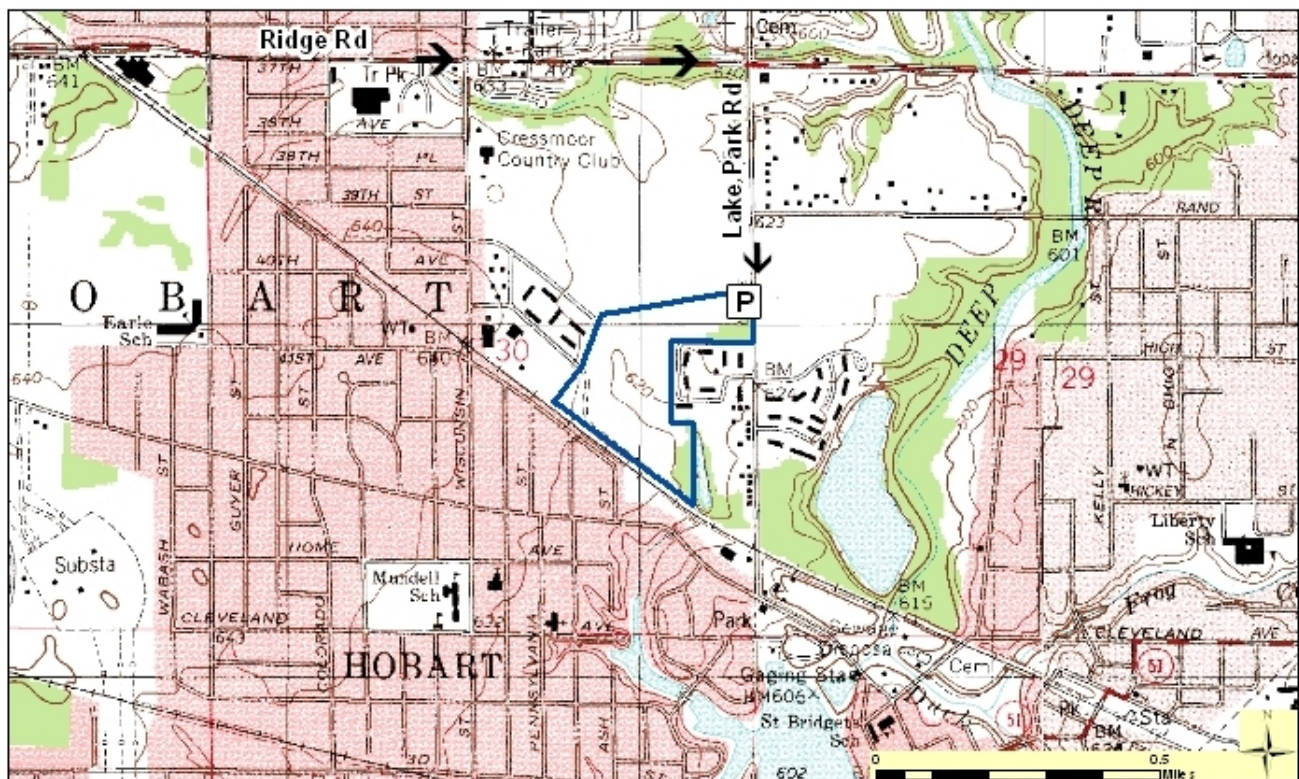

**Description:** Cressmoor Prairie is one of the largest protected examples of a silt-loam or “black soil” prairie in Indiana. Black soil prairies were once the most common prairies in Indiana. However, their rich, fertile soil was among the very finest agricultural ground anywhere in the world, so most were plowed under for farming. As a result, black soil prairies are exceedingly rare. Over 250 species of plants have been found at Cressmoor Prairie. Typical prairie species occurring here in great numbers include wild quinine, blazing stars, rattlesnake master, prairie dock, and compass plant.

## Further Information:

Shirley Heinze Land Trust, 109 West 700 North, Valparaiso, IN 46385 (219) 242-8558. [www.heinzetrust.org](http://www.heinzetrust.org)  
Division of Nature Preserves, Coastal Regional Ecologist, Derek Nimetz: [dnimetz@dnr.IN.gov](mailto:dnimetz@dnr.IN.gov)  
Indiana Department of Natural Resources